

Vipros III Z/K3510NT with AMNC-F Control Layout Drawings



LAPIS SERVICES
(215) 464-9131

Amada Support,
Rebuilds, Sales And
Fanuc Control Upgrades.



LAPISINC.COM

Amada America Inc.
7025 Firestone Blvd.
Buena Park CA. 90621
Phone: (714) 739 2111
Fax.: (714) 739 4099
Email info@amada.com

Warning

- Qualified personnel must complete all work.
- Do not apply power to the Vipros III 3510NT until an Amada Service Engineer is present and has instructed you to do so.
- Not all information required to install the Vipros III 3510 NT is included with this document. Specific details for proper installation are found in the document *Vipros III 3510 NT with AMNC-F User Pre-installation Guide* available at the Amada America Internet web site at <http://www.amada.com/>.
- Considerable effort has been made to ensure that this manual is free of inaccuracies and omissions. However, as we are constantly improving our product, some of the data contained herein may be out of date. Please check our Internet site, <http://www.amada.com/>, for the latest release of this document.



LAPIS SERVICES
(219) 464-9131

Amada Support,
Rebuilds, Sales And
Fanuc Control Upgrades.

LAPISINC.COM

Contents

Planning the Location of the Vipros III 3510 NT 4

Plan View - Vipros III 3510 NT 5

Plan View - Vipros III 3510 NT (shown with optional MP1225 Loader) 6

Detailed Plan View - Vipros III 3510 NT 7

Elevation View - Vipros III 3510 NT 8

End View - Vipros III 3510 NT 9

Conveyor Options – Single Steel Track Conveyor 10

Conveyor Options – Rubber Belt Dual Conveyor 11

Conveyor Options – “Generic” Dual Rubber Belt Conveyor 12

Chiller Placement 13



LAPIS SERVICES
(219) 464-9131

**Amada Support,
 Rebuilds, Sales And
 Fanuc Control Upgrades.**

LAPISINC.COM

Planning the Location of the Vipros III 3510 NT

The following diagrams provide the details for positioning the Vipros III 3510 NT.

- ❑ No obstacles are allowed in the worksheet travel area and the ceiling must be at least 40" above the Vipros III 3510 NT.
- ❑ All of the recommended maintenance areas should be used, but at a minimum the doors of the NC unit must be able to be opened. Any reduction of the listed maintenance areas may increase time and expense of installation and maintenance.
- ❑ The Vipros III 3510 NT machine and control must be protected from direct sunlight or other heat sources. Direct exposure to direct heating sources such as infrared heaters have been shown to affect punch and die alignment.
- ❑ The positioning of the SBC EX5.5 Chiller is very flexible.



LAPIS SERVICES
(219) 464-9131

Amada Support,
Rebuilds, Sales And
Fanuc Control Upgrades.

LAPISINC.COM

Plan View - Vipros III 3510 NT

Electrical Requirements	
E1	Vipros III Z/K 3510NT 200/ 3 / 60 ±10%, 30 kVA 86 amps @ 200VAC / 3phase / 60 hz. To operate at 230 / 460 VAC a step up transformer is required.
E2	SBC EX5.5 Chiller 230 or 460 / 3 / 60 ±10% 15 kVA 19 amps @ 460 / 3 / 60 VAC

Compressed Air Requirements	
A1	Vipros III K 3510NT 80 psi @ 8.8 ft3/min. Vipros III Z 3510NT 80 psi @ 19 ft3/min.

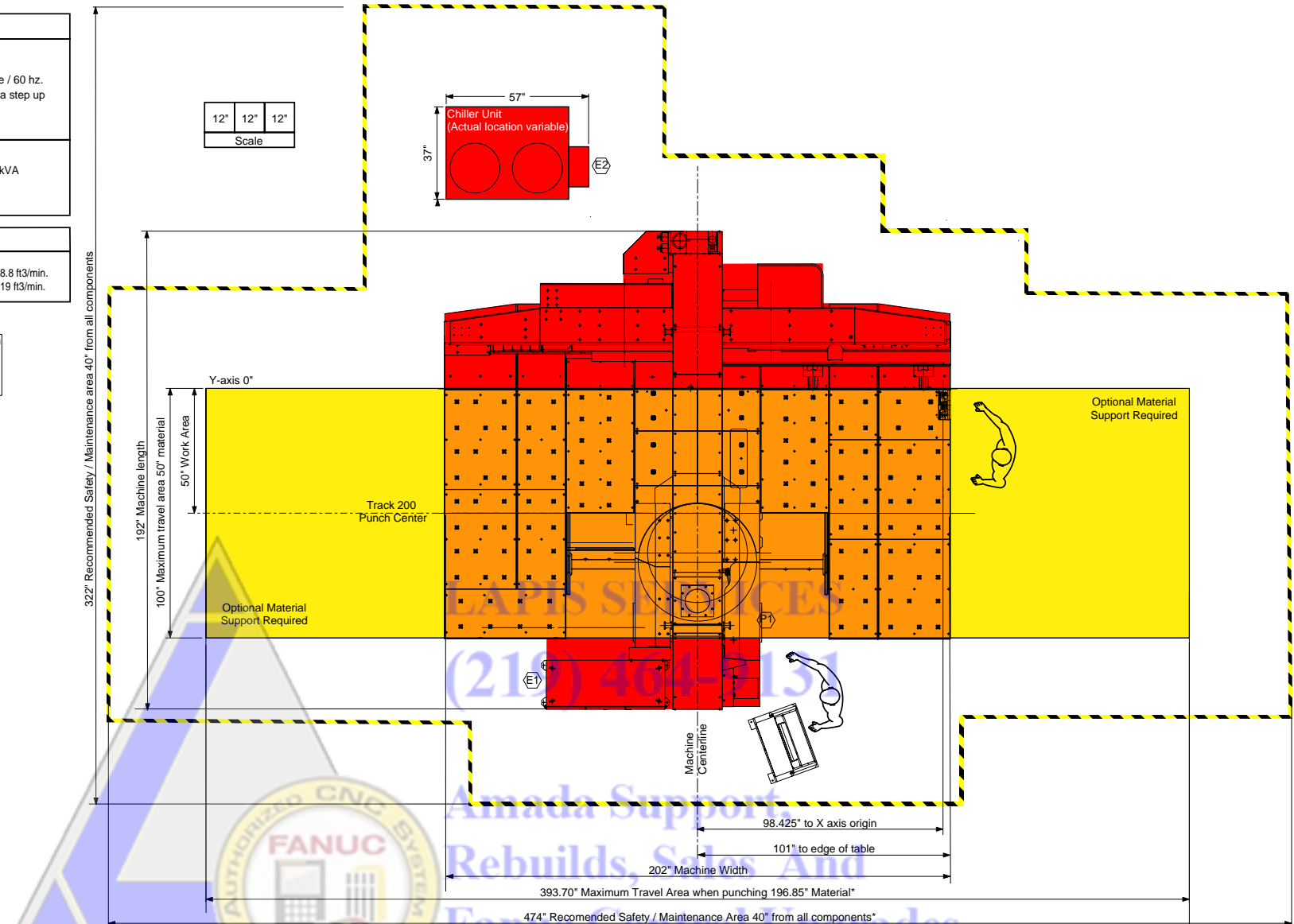

474" Recommended Safety / Maintenance Area 40" from all components*
 * Actual clearance depends on the maximum size of the material that will be punched
 - Always use sub tables to support sheets larger than 100"

Plan View - Vipros III 3510 NT (shown with optional MP1225 Loader)

Electrical Requirements	
E1	Vipros III Z/K 3510NT 200 / 3 / 60 ±10%, 30 kVA 86 amps @ 200VAC / 3phase / 60 hz. To operate at 230 / 460 VAC a step up transformer is required.
E2	SBC EX5.5 Chiller 230 or 460 / 3 / 60 ±10% 15 kVA 19 amps @ 460 / 3 / 60 VAC
E5	MP1225 Loader 200 / 3 / 60 ±10%, 10 Kva To operate at 230 / 460 VAC a step up transformer is required.
Compressed Air Requirements	
A1	Vipros III K 3510NT 80 psi @ 8.8 ft ³ /min. Vipros III Z 3510NT 80 psi @ 19 ft ³ /min.
A2	MP1225 Loader 80 psi @ 31.8 ft ³ /min.

Operator Control Station

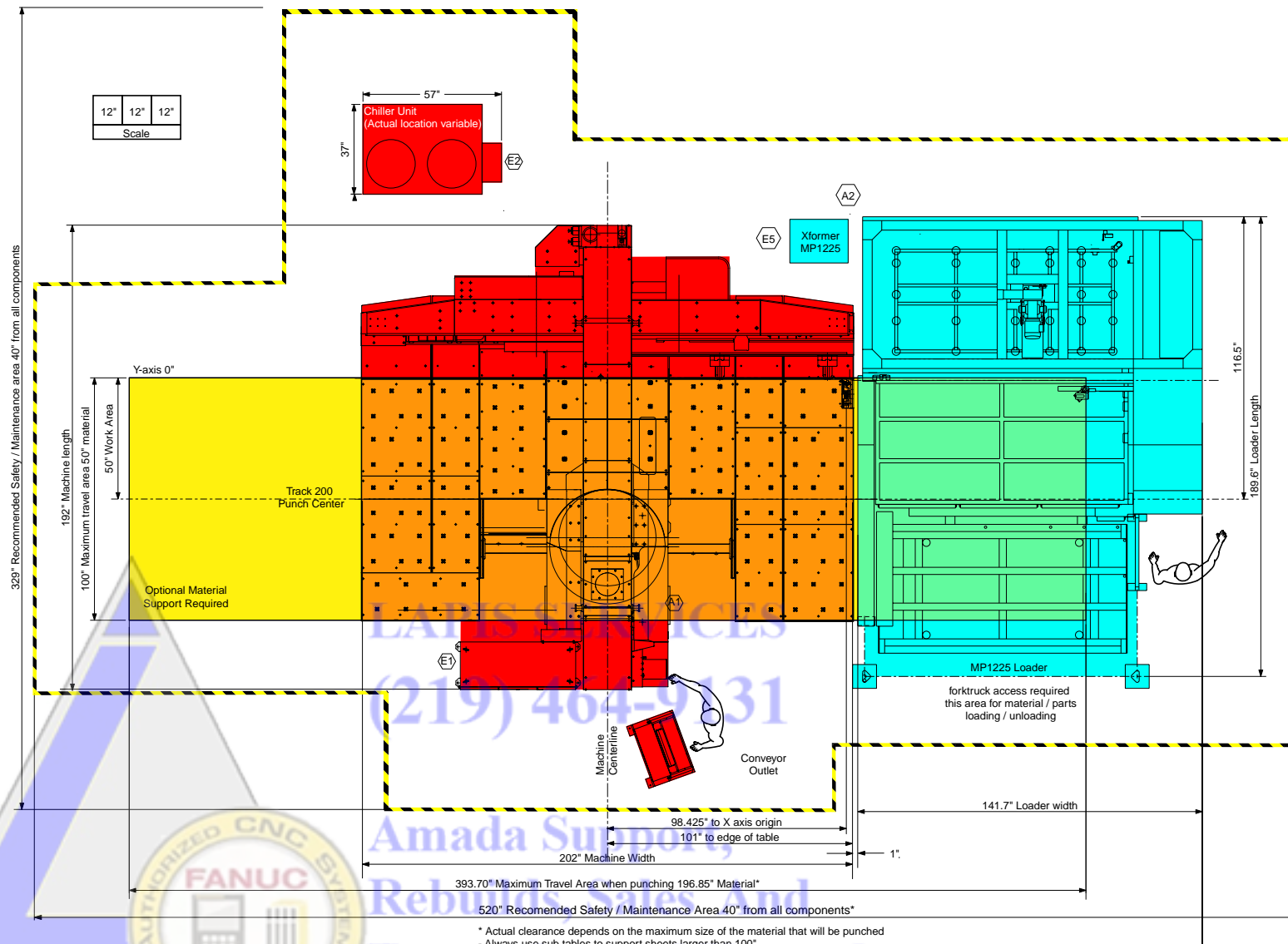

Detailed Plan View - Vipros III 3510 NT

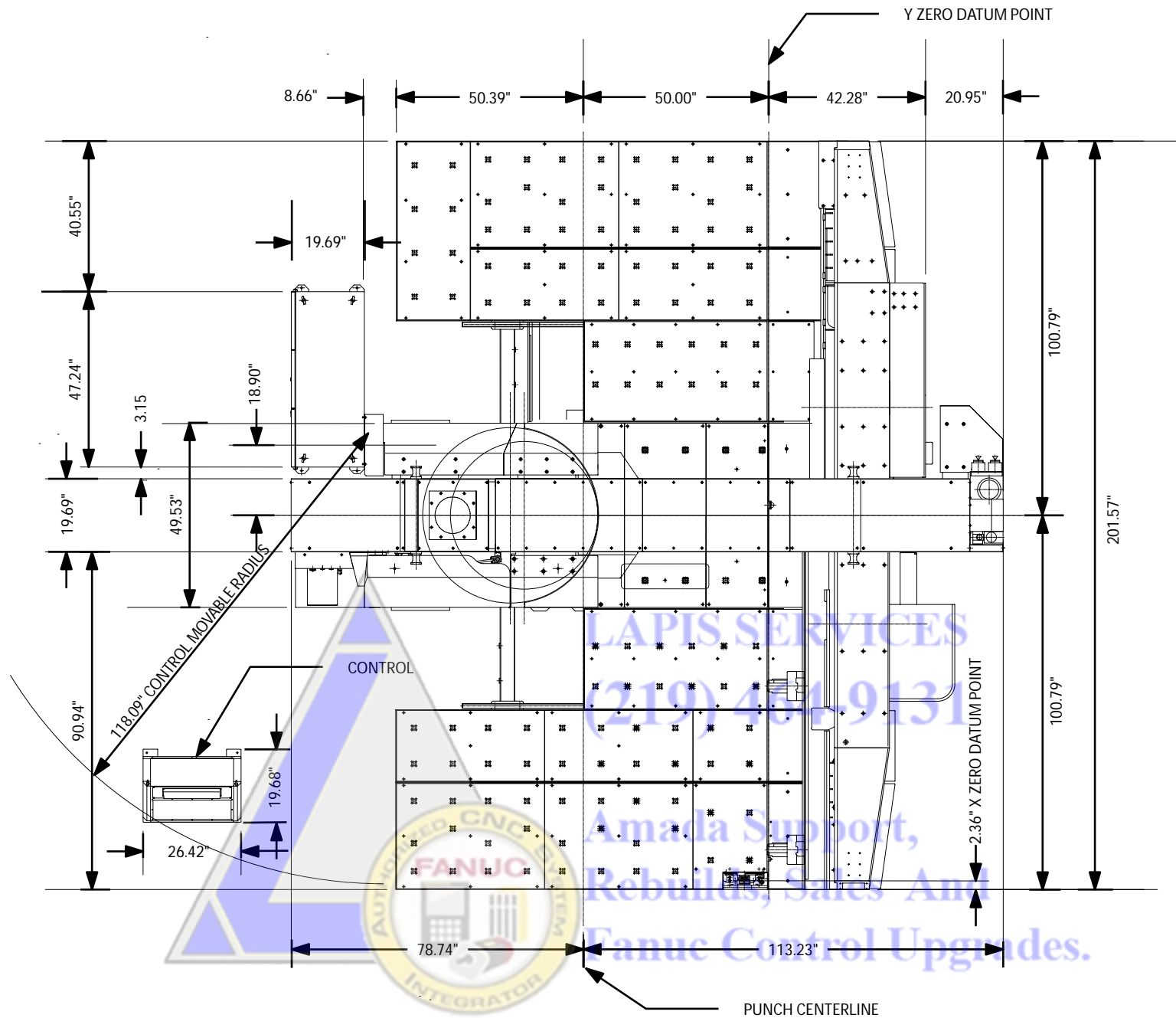

Elevation View - Vipros III 3510 NT

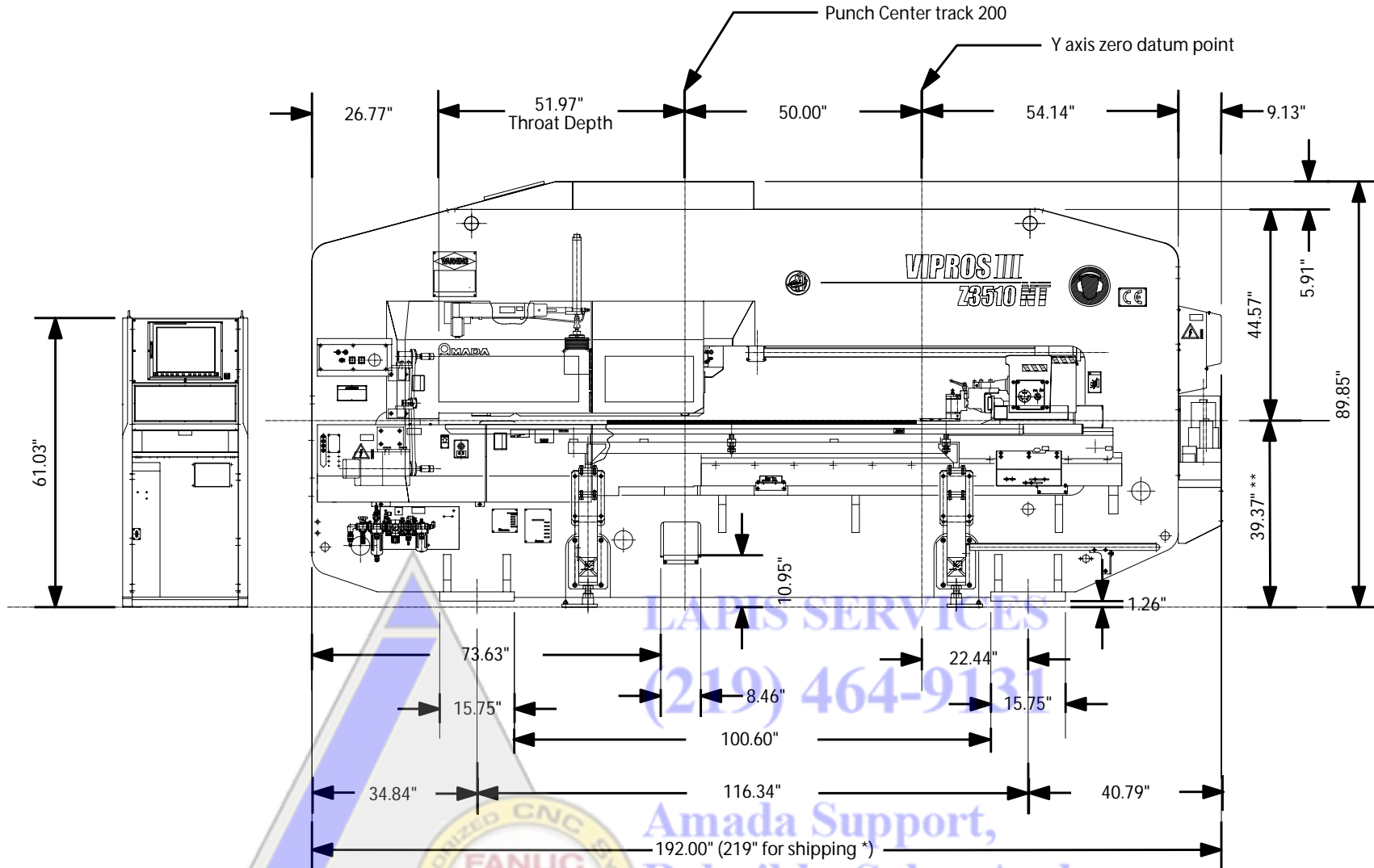

* Electrical Cabinet is attached to left side of frame for shipping adding 27" to overall length

** Material Pass line may vary due to installation of different options

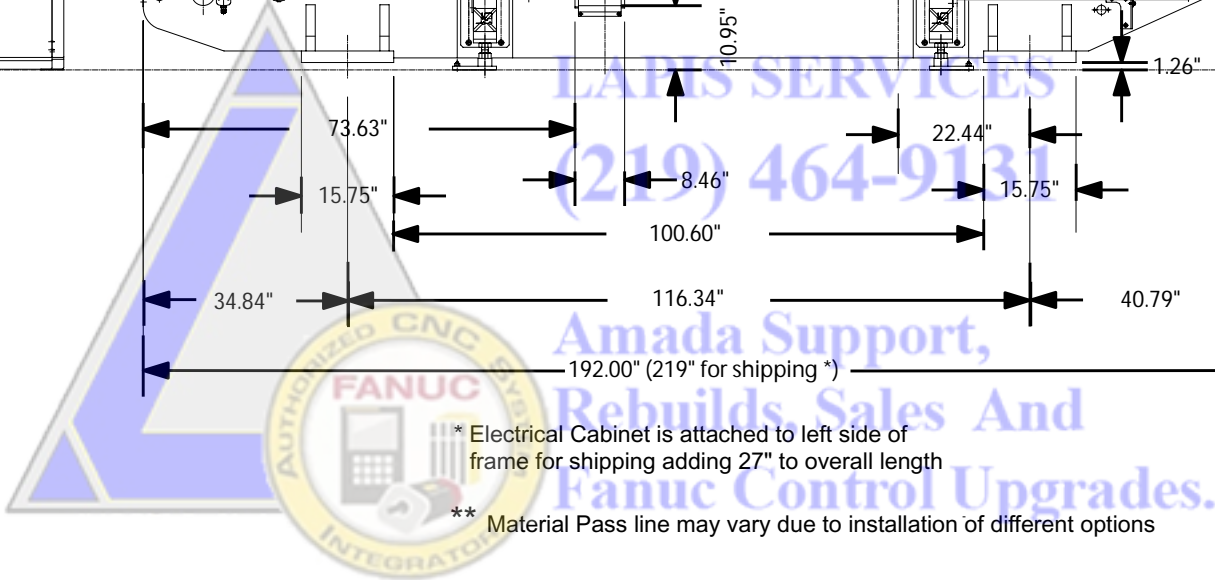

End View - Vipros III 3510 NT

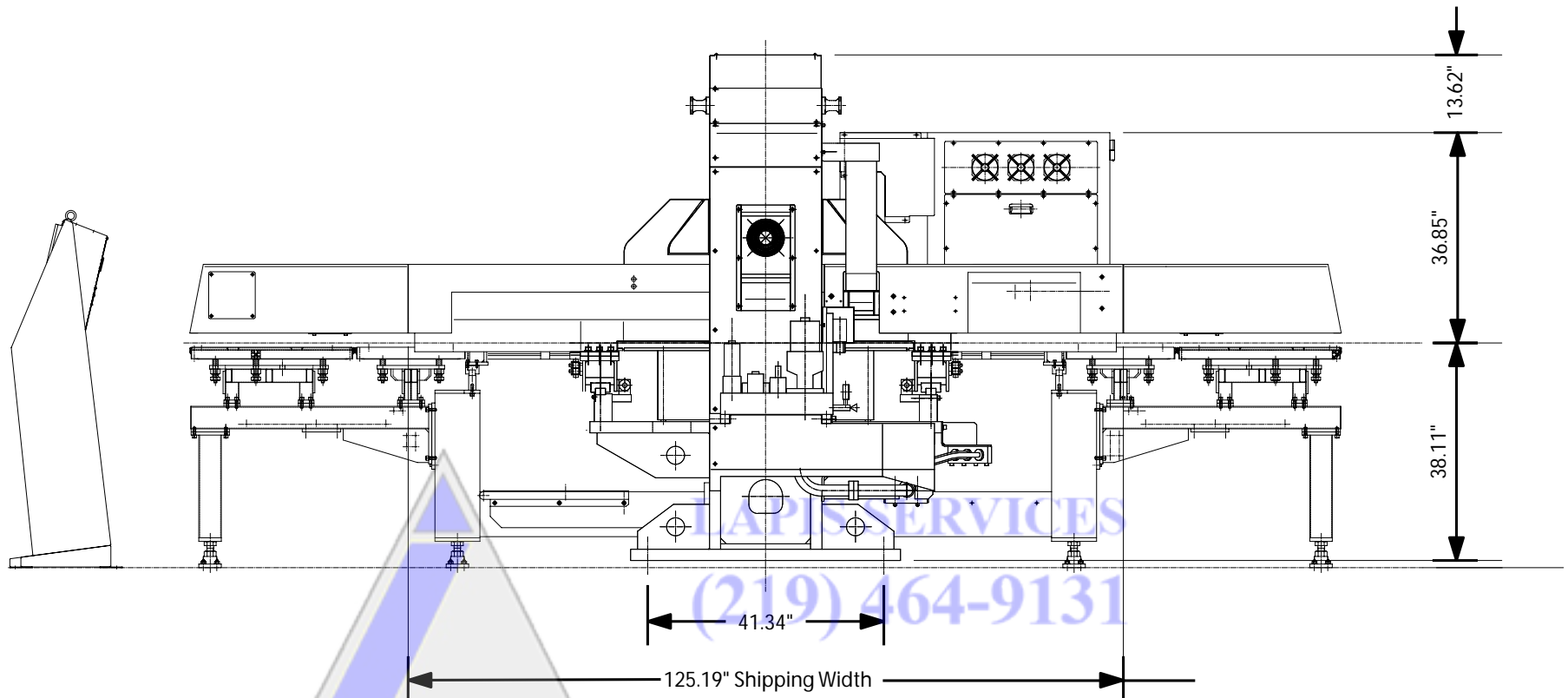

Amada Support,
Rebuilds, Sales And
Fanuc Control Upgrades.



LAPISINC.COM

Conveyor Options – Single Steel Track Conveyor

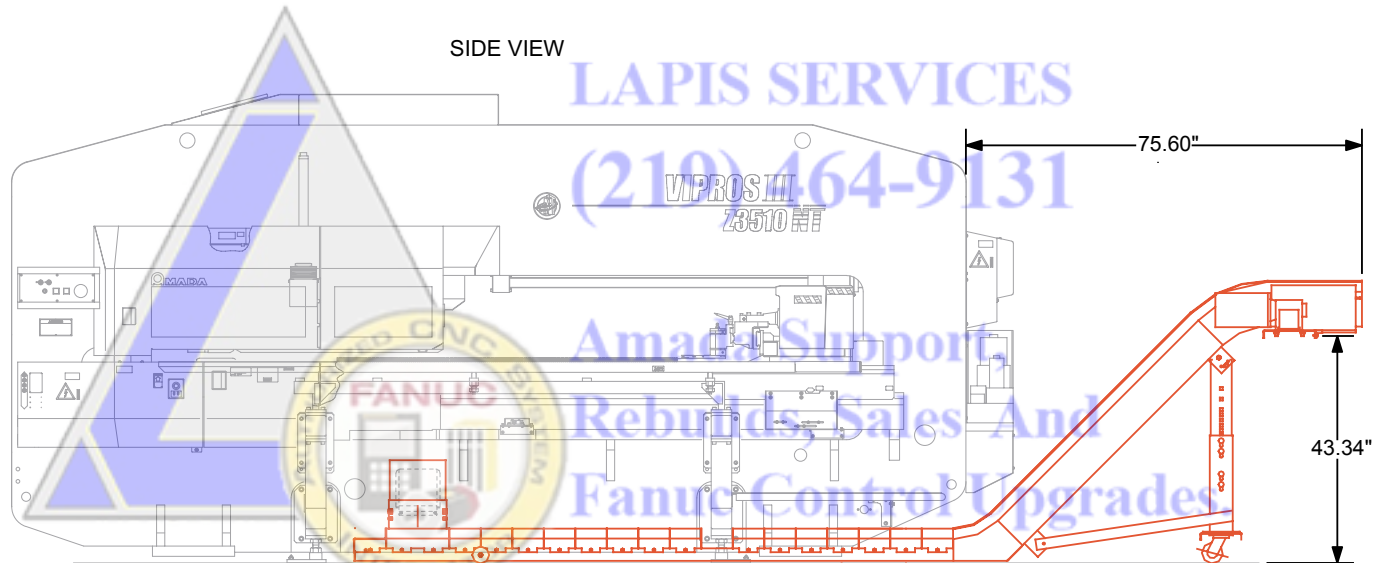
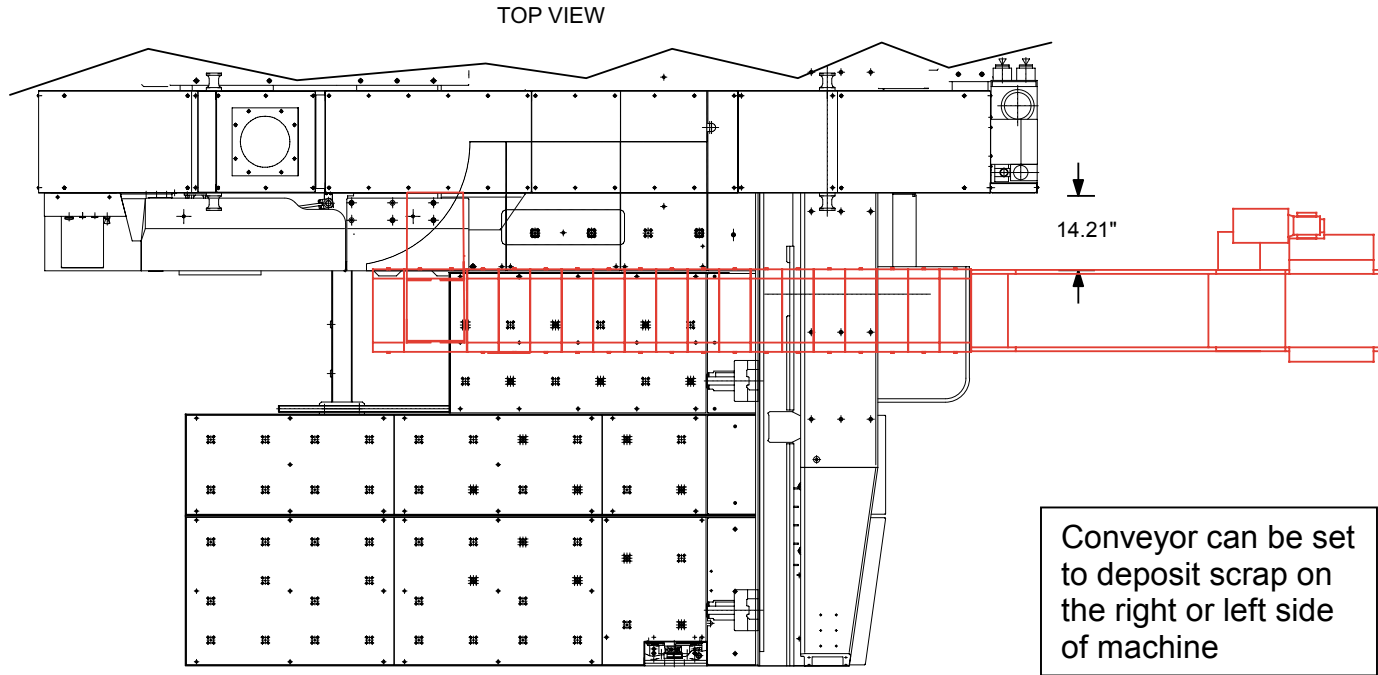

Conveyor Options – Rubber Belt Dual Conveyor

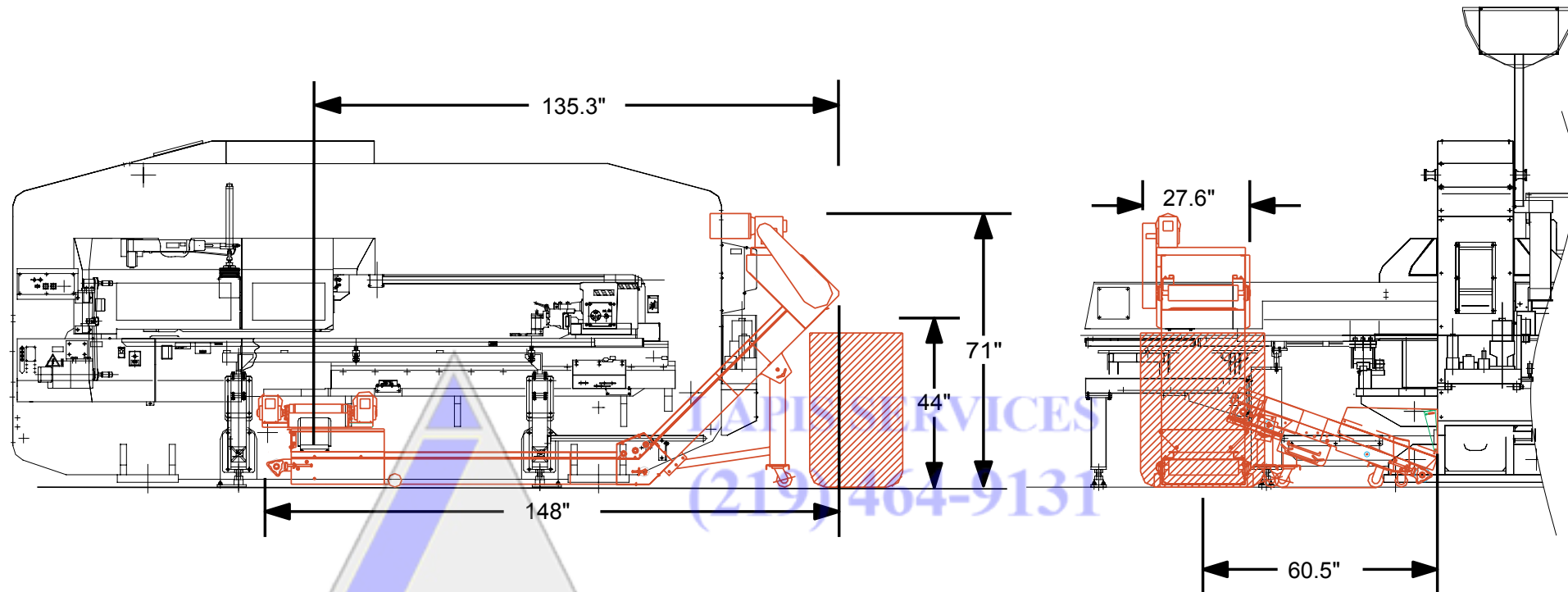

Conveyors can be set to deposit scrap on the right or left side of machine

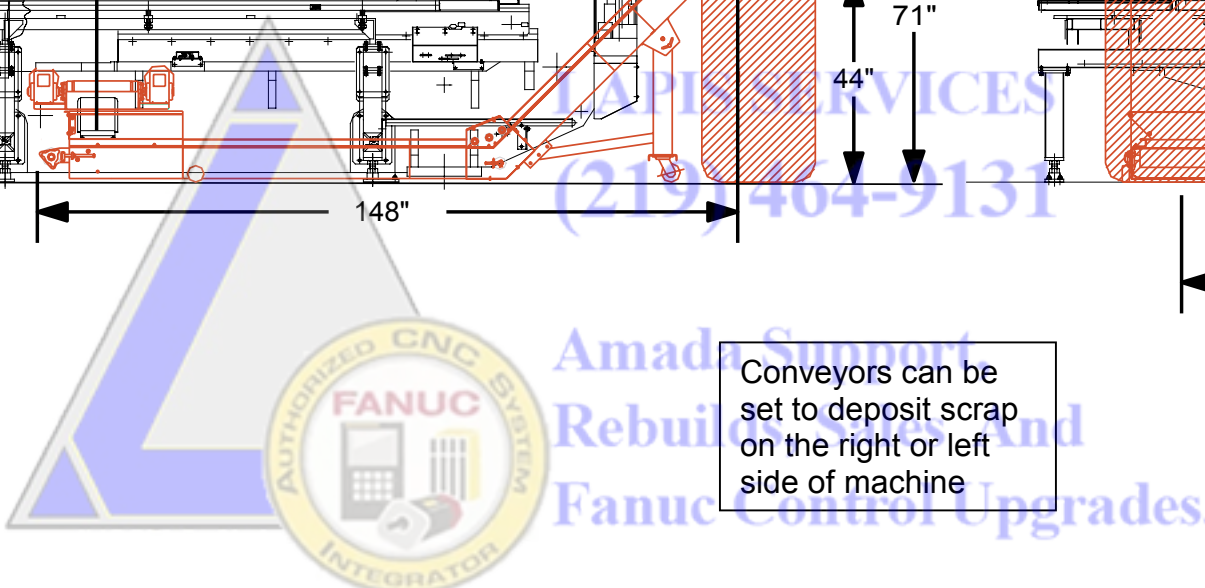

Conveyor Options – “Generic” Dual Rubber Belt Conveyor

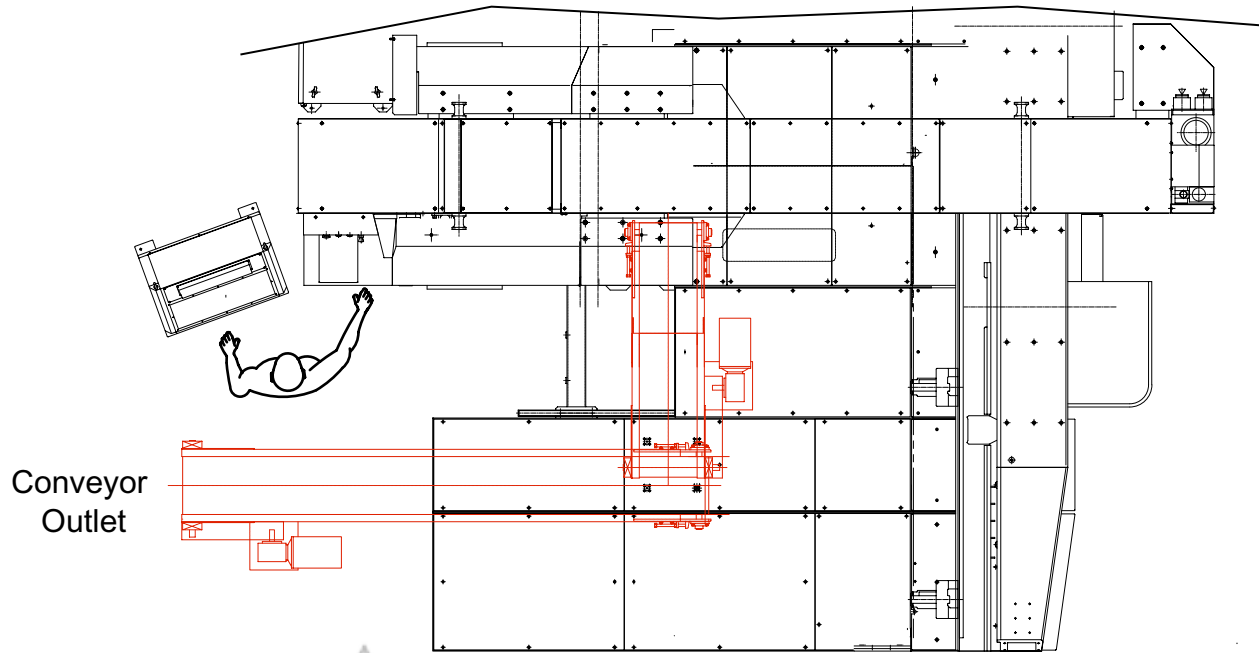

Conveyors can be set to deposit scrap on the right or left side of machine

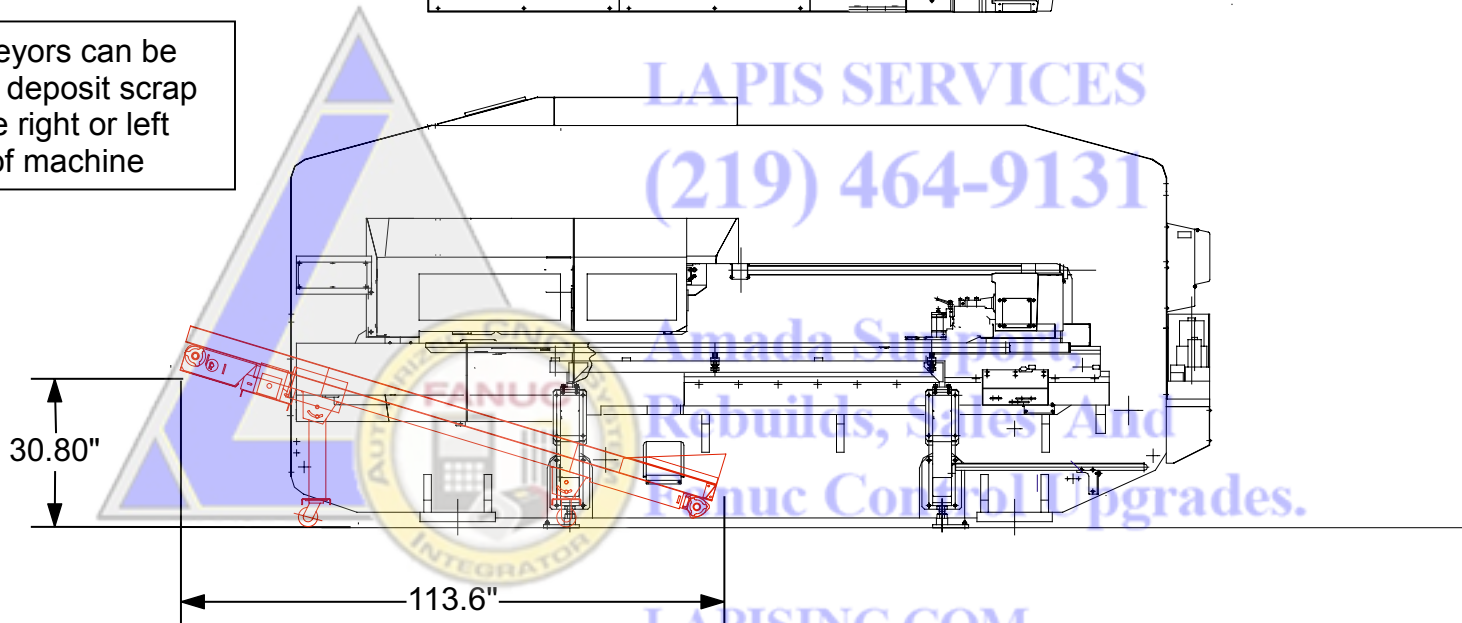

Chiller Placement

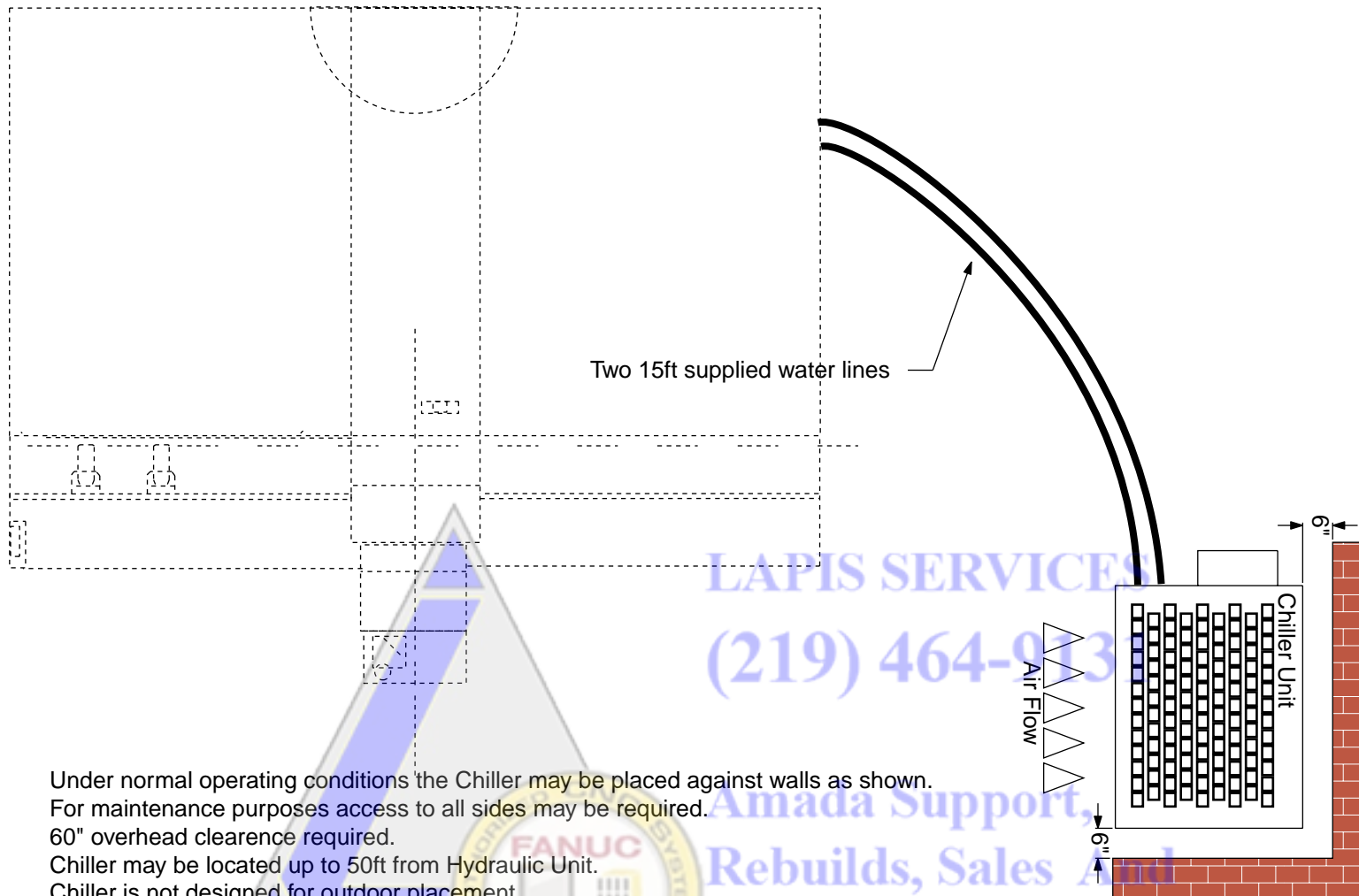

Under normal operating conditions the Chiller may be placed against walls as shown. For maintenance purposes access to all sides may be required. 60" overhead clearance required. Chiller may be located up to 50ft from Hydraulic Unit. Chiller is not designed for outdoor placement.

LAPIS SERVICES
(219) 464-9133
Amada Support,
Rebuilds, Sales And
Fanuc Control Upgrades.

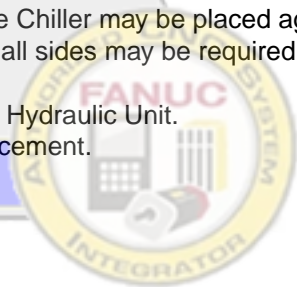

LAPISINC.COM